

## SHLP 2 Horizontal Multistage Pumps

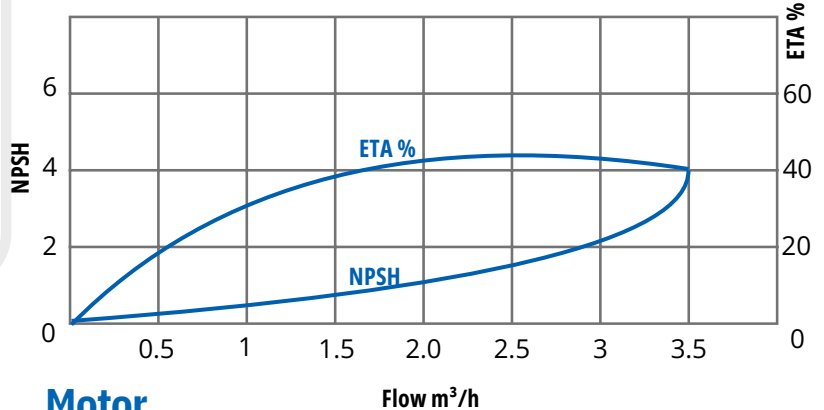

### Performance Curves

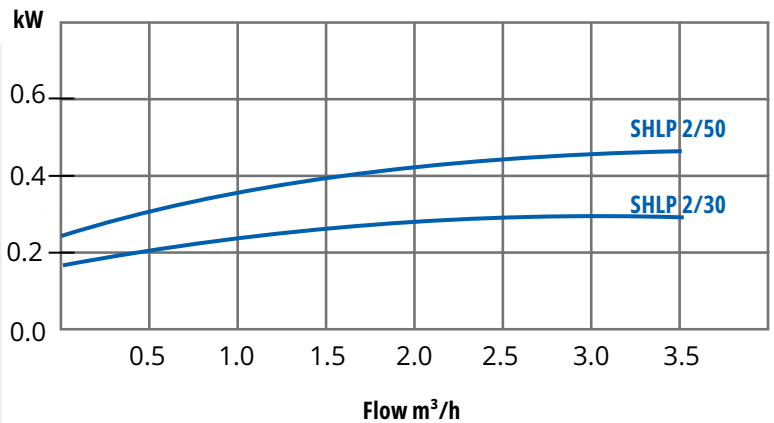
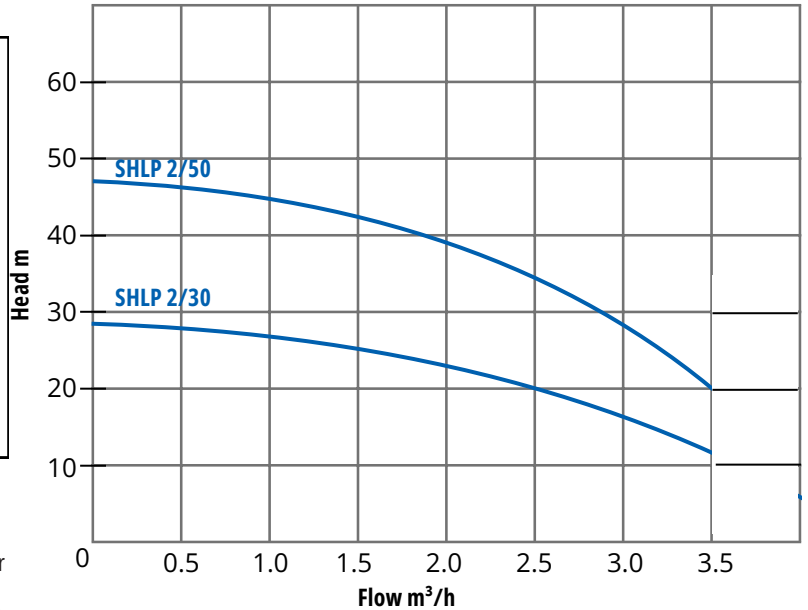

### Typical Applications

- Air-Conditioning System: Ensures efficient water circulation in large-scale air conditioning systems for consistent temperature control.
- Cooling System: Provides reliable water flow for cooling processes in industrial machinery and equipment, preventing overheating.
- Industrial Cleaning: Supplies high-pressure water for thorough cleaning in industrial environments, enhancing cleanliness and safety.
- Water Treatment (Water Purification): Facilitates the movement of water in purification systems, ensuring safe and clean water supply.
- Aquaculture: Delivers oxygenated water for fish farming, supporting healthy aquatic life and sustainable farming practices.
- Fertilizing/Metering System: Accurately meters and delivers water mixed with fertilizers for efficient agricultural irrigation.
- Environmental Applications: Supports environmental protection systems by circulating water in pollution control and remediation projects.
- Pressure Boosting in Industrial Applications: Enhances water pressure in various industrial processes, ensuring consistent and reliable operation.
- Firefighting Systems: Provides a reliable water supply for firefighting systems, ensuring rapid response to fire emergencies.
- Domestic Water Supply: Ensures consistent water pressure and supply for residential buildings, improving water distribution efficiency.
- Boiler Feedwater Systems: Pumps water into boilers at high pressure, ensuring efficient steam generation for power and heating.
- Irrigation Systems: Delivers water with sufficient pressure for extensive agricultural irrigation, promoting crop growth and yield.

### Operating Conditions

- Pumped liquids: Thin, clean, non-aggressive and non-explosive liquids without solid particles or fibres.
- Liquid Temperature Range: 0°C to +90°C.
- Max. Ambient Temperature: +50°C
- Max. Suction Lift: According to the NPSH curve plus a safety margin of 1.0m
- Max. Inlet Pressure: 6 bars
- Max. Operating Pressure: 10Bar up to 40°C, 6 Bar up to 90°C

### Motor

- Enclosure Class: IP54
- Insulation Class: F
- Voltage: 1x240V
- Speed: 2900rpm

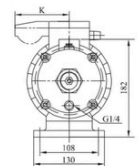

### Technical Data

Model	Power		Dimensions (mm)						Weight (kg)
	kW	HP	L1	L2	L3	D	H	K	
SHLP 2/30	037	0.5	323	105	102	141	215/230	62	10
SHLP 2/50	0.55	0.75	359	141	138	141	215/230	62	11

